

Applications:

Liquid fillable, thermoplastic solid front, blowout back safety case.
Used where operat safety process, chemical and petroleum industries, highly corrosive media.



Specifications:

■ Dial	4.5" (115mm)
■ Case	Black impact resistant thermoplastic solid front blowout back safety
■ Lens	Polycarbonate
■ Ring	Ethylene Propylene
■ Pointer	Black Aluminum micrometer adjustable
■ Internal	Stainless steel / Brass
■ Connection	1/4" or 1/2" NPT
■ Range	30" Hg Vac/KPA -- 0-1000 PSI/KPA
■ Accuracy	±0.8%

4.5" Back Connection

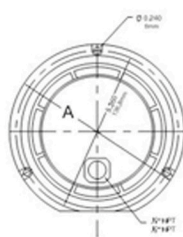

4.5" Bottom Connection with Integral Back Flange

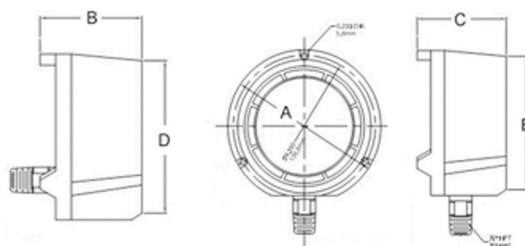

Dial	A	B	C	D	E
4.5" (115mm)	5.835" (148.1mm)	3.38" (86mm)	3.400" (86.3mm)	4.53" (115mm)	5.100" (129.4mm)